

SubConn® Ethernet Low Profile

9 contacts

Connector specifications

Voltage rating	250 V AC rms
DC rating	85% of above AC rating
Data rate	1 Gbit/s (up to 75 m)
Insulation resistance	> 200 Mohm
Contact resistance	< 0.01 ohm
Wet matings	> 500
Temperature rating (water)	- 4 to 60°C, 25 to 140°F
Temperature rating (air)	- 40 to 60°C, - 40 to 140°F
Storage temperature rating	- 40 to 60°C, - 40 to 140°F
Depth rating	600 bar, 8,700 psi
Depth rating PEEK	300 bar, 4,350 psi

Material specifications

Connector body	Chloroprene rubber
Bulkhead body	Brass, stainless steel, titanium, anodised aluminium or PEEK
Contacts	Female sockets in gold plated brass UNS - C36000 Male pins in gold plated beryllium copper
O-rings	Nitrile
Locking straps	Chloroprene rubber
Inline cable (100 cm, 3.3 ft)	4 pair 24 AWG, 0.20 mm ² PUR Screen: Tinned copper braid
Bulkhead leads (100 cm, 3.3 ft)	CAT 5E patch cable incl. RJ 45 connector (not installed)

Face view (male)



Inline cable colour code

- *1-2: Brown, Brown/white
- *3-4: Blue, Blue/white
- *5-6: Orange, Orange/white
- * Twisted pairs
- *7-8: Green, Green/white
- 9: Screen (orange wire on bulkhead)

Nominal cable outside diameter (OD)

PUR cable 0.410", 10.4 mm

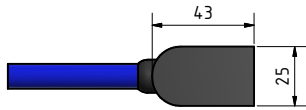

DLPIL9F

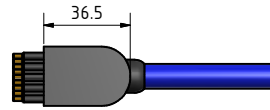

DLPIL9M

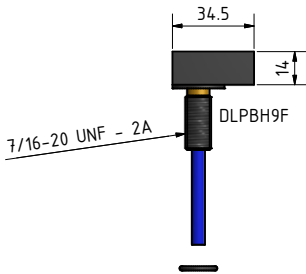
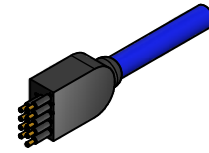

DLPBH9F

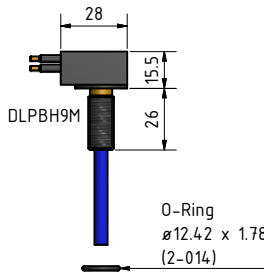

DLPBH9M

O-Ring
ø12.42 x 1.78
(2-014)

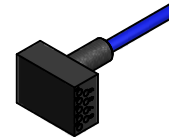

DLPDC9F



DLPDC9M

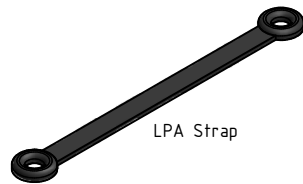
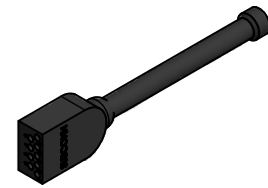

LPA Strap

Drawing information

Dimensions in mm (1 mm = 0.03937 inch)
Threads in inches (1 inch = 25.4 mm)