

SubConn® Micro Low Profile 7 and 9 contacts

Connector specifications

Voltage rating	300 V AC rms
DC rating	85% of above AC rating
Current rating	5 A per contact (max 20 A per connector)
Insulation resistance	> 200 Mohm
Contact resistance	< 0.01 ohm
Wet matings	> 500
Temperature rating (water)	- 4 to 60°C, 25 to 140°F
Temperature rating (air)	- 40 to 60°C, - 40 to 140°F
Storage temperature rating	- 40 to 60°C, - 40 to 140°F
Depth rating	700 bar, 10,000 psi
Depth rating PEEK	300 bar, 4,350 psi

Material specifications

Connector body	Chloroprene rubber
Bulkhead body	Brass, stainless steel, titanium, anodised aluminium or PEEK
Contacts	Female sockets in gold plated brass UNS - C36000 Male pins in gold plated beryllium copper
O-rings	Nitrile
Locking straps	Chloroprene rubber
Inline cable (60 cm, 2 ft)	20 AWG 0.52 mm ² chloroprene rubber
Bulkhead leads (30 cm, 1 ft)	20 AWG 0.52 mm ² tagged PTFE

Face view (male)

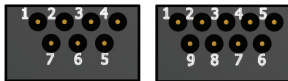

Inline cable colour code

1 Black	4 Green	7 White/black	10 Orange/black**
2 White	5 Orange	8 Red/black*	
3 Red	6 Blue	9 Green/black	

* Micro 7 contacts connector uses an 8 conductor cable (only 7 conductors are used)

** Micro 9 contacts connector uses an 10 conductor cable (only 9 conductors are used)

Nominal cable outside diameter (OD)

8 conductor cable	0.363", 9.2 mm
10 conductor cable	0.406", 10.3 mm

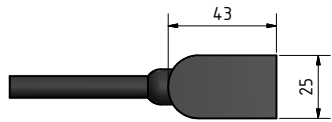

MCLPIL7F

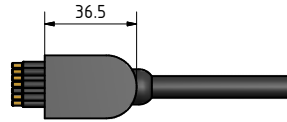

MCLPIL7M

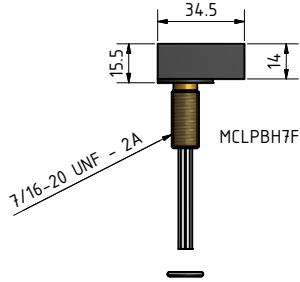
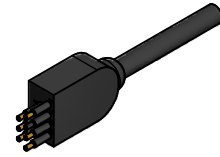

MCLPBH7F

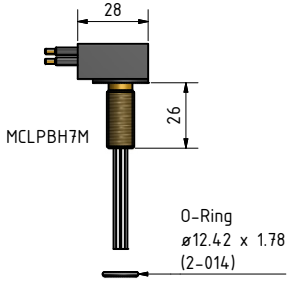

MCLPBH7M

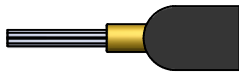
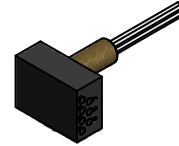

MCLPOM7F



MCLPOM7M

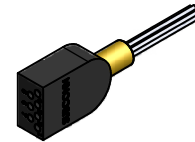

MCLPDC7F



MCLPDC7M

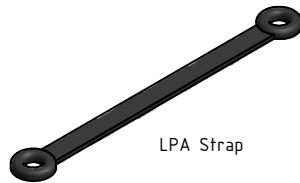
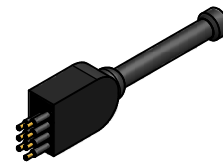

LPA Strap

Drawing information

Dimensions in mm (1 mm = 0.03937 inch)
Threads in inches (1 inch = 25.4 mm)