

# SubConn® Micro Circular

## 21 contacts

### Connector specifications

Voltage rating	300 V AC rms
DC rating	85% of above AC rating
Current rating	5 A per contact (max 40 A per connector)
Insulation resistance	> 200 Mohm
Contact resistance	< 0.01 ohm
Wet matings	> 500
Temperature rating (water)	- 4° to 60°C, 25 to 140°F
Temperature rating (air)	- 40 to 60°C, - 40° to 140°F
Storage temperature rating	- 40 to 60°C, - 40 to 140°F
Depth rating	700 bar, 10,000 psi
Depth rating PEEK	300 bar, 4,350 psi

### Material specifications

Connector body	Chloroprene rubber
Bulkhead body	Brass, stainless steel, titanium, anodised aluminium or PEEK
Contacts	Female sockets in gold plated brass UNS - C36000 Male pins in gold plated beryllium copper
O-rings	Nitrile
Locking sleeves	POM
Snap rings	Stainless steel AISI 302
Inline cable (60 cm, 2 ft)	20 AWG 0.52 mm <sup>2</sup> PUR
Bulkhead leads (30 cm, 1 ft)	20 AWG 0.52 mm <sup>2</sup> tagged PTFE

### Face view (male)



### Inline cable colour code

1-21 Tagged numbering

### Nominal cable outside diameter (OD)

21 conductor cable 0.578" 14,70 mm

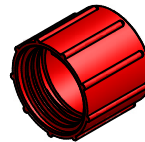
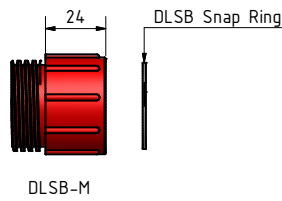
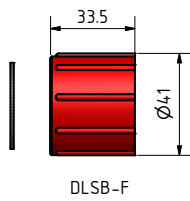
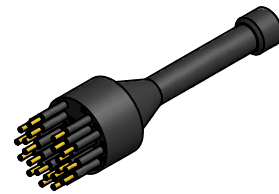
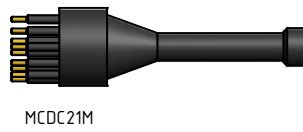
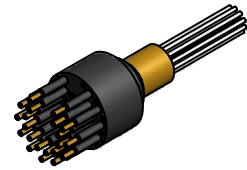
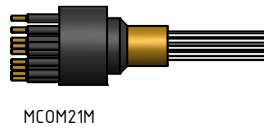
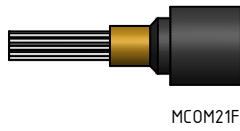
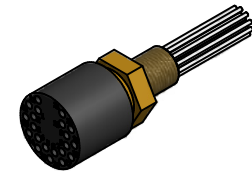
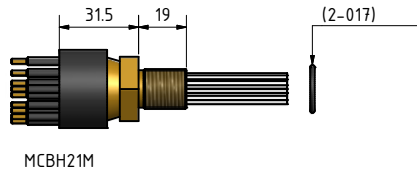
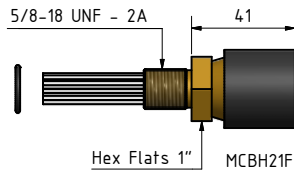
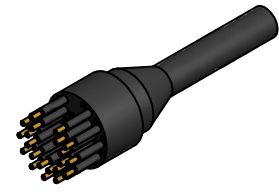
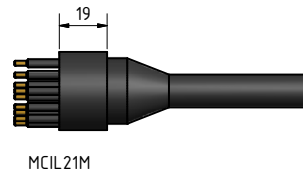
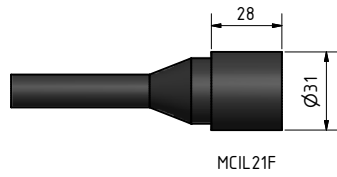

**Drawing information**

Dimensions in mm (1 mm = 0.03937 inch)  
Threads in inches (1 inch = 25.4 mm)